

The reproduction, distribution and utilization of this document as well as the communication of its contents to others without explicit authorization is prohibited. Offenders will be held liable for the payment of damages. All rights reserved in the event of the grant of a patent, utility model or design.

Variante A
gezeichnete Ausführung Z.-Nr.08
Drawn version dwg No 08

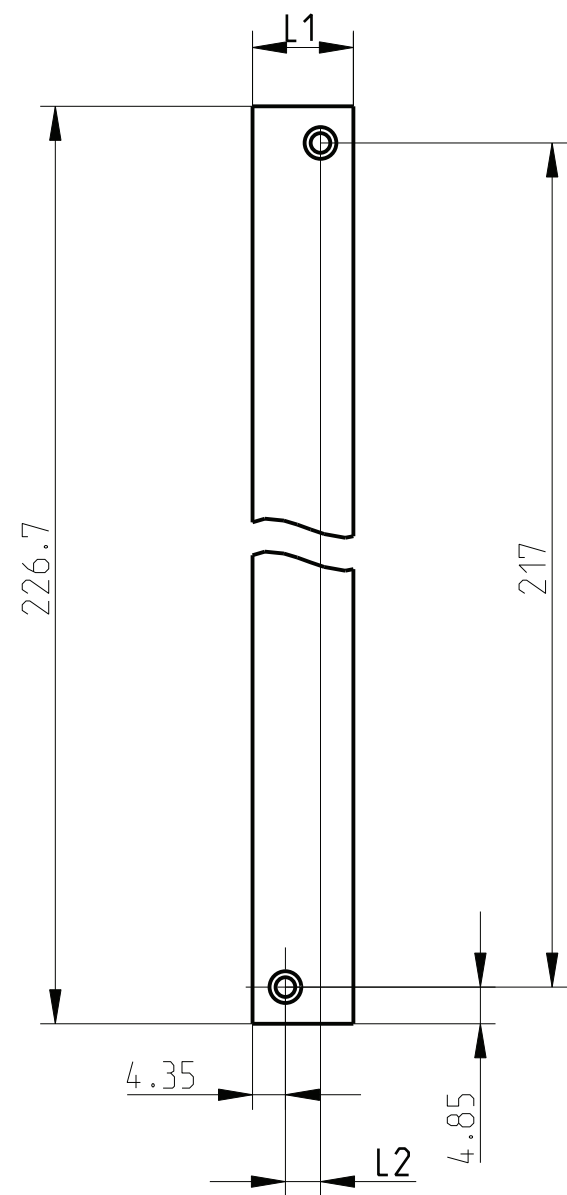

Variante B
gezeichnete Ausführung Z.-Nr.14
Drawn version dwg No 14

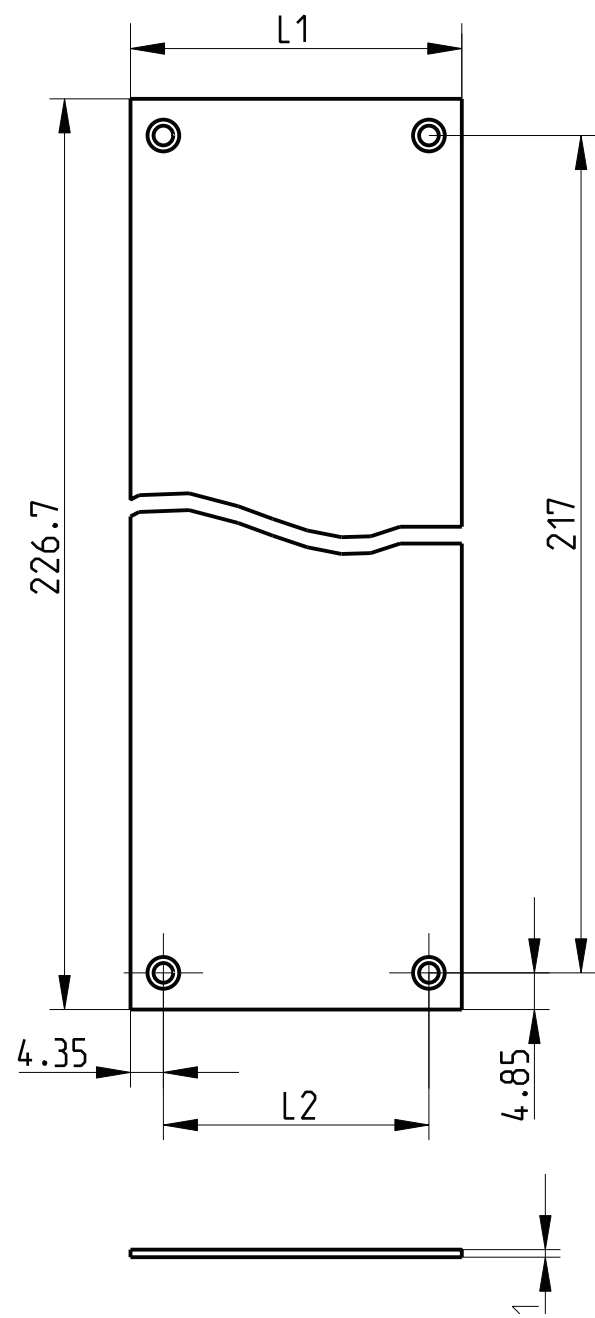

- 1) entfettet/degreased
- 2) Standardprodukt: alle weiteren Typen auf Anfrage
Standard product: all other types on request
- 3) Technische Aenderungen vorbehalten
Subject to change without notice

Dieses Bauteil unterliegt den Reglementierungen der RoHS Richtlinie und deren Umsetzung im ElektroG.

This component is subject to the RoHS directive and its applications within the Electrical and Electronic Equipment Act (ElektroG).

Art.Nr.	Zeichnungs Nr.				Zeichnungs Nr.			
Part No.	Drawing No	Var.	L1	L2	Drawing No	Var.	L1	L2
2) 3687562	226 215.0209.08	A	13,34	4,64	226 215.0209.50	B	226,70	218,00
	226 215.0209.09	B	18,42	9,72	226 215.0209.51	B	231,78	223,08
2) 3685701	226 215.0209.10	B	23,50	14,80	226 215.0209.52	B	236,86	228,16
	226 215.0209.11	B	28,58	19,88	226 215.0209.53	B	241,94	233,24
2) 3685702	226 215.0209.12	B	33,66	24,96	226 215.0209.54	B	247,02	238,32
	226 215.0209.13	B	38,74	30,04	226 215.0209.55	B	252,10	243,40
2) 3685703	226 215.0209.14	B	43,82	35,12	226 215.0209.56	B	257,18	248,48
	226 215.0209.15	B	48,90	40,20	226 215.0209.57	B	262,26	253,56
	226 215.0209.16	B	53,98	45,28	226 215.0209.58	B	267,34	258,64
	226 215.0209.17	B	59,06	50,36	226 215.0209.59	B	272,42	263,72
	226 215.0209.18	B	64,14	55,44	226 215.0209.60	B	277,50	268,80
	226 215.0209.19	B	69,22	60,52	226 215.0209.61	B	282,58	273,88
2) 3685704	226 215.0209.20	B	74,30	65,60	226 215.0209.62	B	287,66	278,96
	226 215.0209.21	B	79,38	70,68	226 215.0209.63	B	292,74	284,04
	226 215.0209.22	B	84,46	75,76	226 215.0209.64	B	297,82	289,12
	226 215.0209.23	B	89,54	80,84	226 215.0209.65	B	302,90	294,20
	226 215.0209.24	B	94,62	85,92	226 215.0209.66	B	307,98	299,28
	226 215.0209.25	B	99,70	91,00	226 215.0209.67	B	313,06	304,36
2) 3685705	226 215.0209.26	B	104,78	96,08	226 215.0209.68	B	318,14	309,44
	226 215.0209.27	B	109,86	101,16	226 215.0209.69	B	323,22	314,52
	226 215.0209.28	B	114,94	106,24	226 215.0209.70	B	328,30	319,60
	226 215.0209.29	B	120,02	111,32	226 215.0209.71	B	333,38	324,68
	226 215.0209.30	B	125,10	116,40	226 215.0209.72	B	338,46	329,76
	226 215.0209.31	B	130,18	121,48	226 215.0209.73	B	343,54	334,84
	226 215.0209.32	B	135,26	126,56	226 215.0209.74	B	348,62	339,92
	226 215.0209.33	B	140,34	131,64	226 215.0209.75	B	353,70	345,00
	226 215.0209.34	B	145,42	136,72	226 215.0209.76	B	358,78	350,08
	226 215.0209.35	B	150,50	141,80	226 215.0209.77	B	363,86	355,16
	226 215.0209.36	B	155,58	146,88	226 215.0209.78	B	368,94	360,24
	226 215.0209.37	B	160,66	151,96	226 215.0209.79	B	374,02	365,32
	226 215.0209.38	B	165,74	157,04	226 215.0209.80	B	379,10	370,40
	226 215.0209.39	B	170,82	162,12	226 215.0209.81	B	384,18	375,48
	226 215.0209.40	B	175,90	167,20	226 215.0209.82	B	389,26	380,56
	226 215.0209.41	B	180,98	172,28	226 215.0209.83	B	394,34	385,64
2) 3685706	226 215.0209.42	B	186,06	177,36	226 215.0209.84	B	399,42	390,72
	226 215.0209.43	B	191,14	182,44				
	226 215.0209.44	B	196,22	187,52				
	226 215.0209.45	B	201,30	192,60				
	226 215.0209.46	B	206,38	197,68				
	226 215.0209.47	B	211,46	202,76				
	226 215.0209.48	B	216,54	207,84				
	226 215.0209.49	B	221,62	212,92				

	Toleranzen tolerances		Oberfläche surface 1)		Maßstab/scale 1:1		1 Blätter sheets
					Aluminium		
			Date	10.08.95	Deckblech geschlossen Cover plate closed		1 Blatt sheet
			Name	Kon./Fr ð			
b	HT0120	27.05.13	Kör.	Prf. Schaffer	für LP 220 / for PCB 220 mm für Steckblock / for Box type plug-in		1 Blatt sheet
a	R269	25.04.05	Vish				
Rev.	Rev no.	Date	Name	HEITEC		226 215.0209.08-84 MB b	

CAD