

gezeichnete Ausführung Z.-Nr.:60
 Drawn version dwg No 60

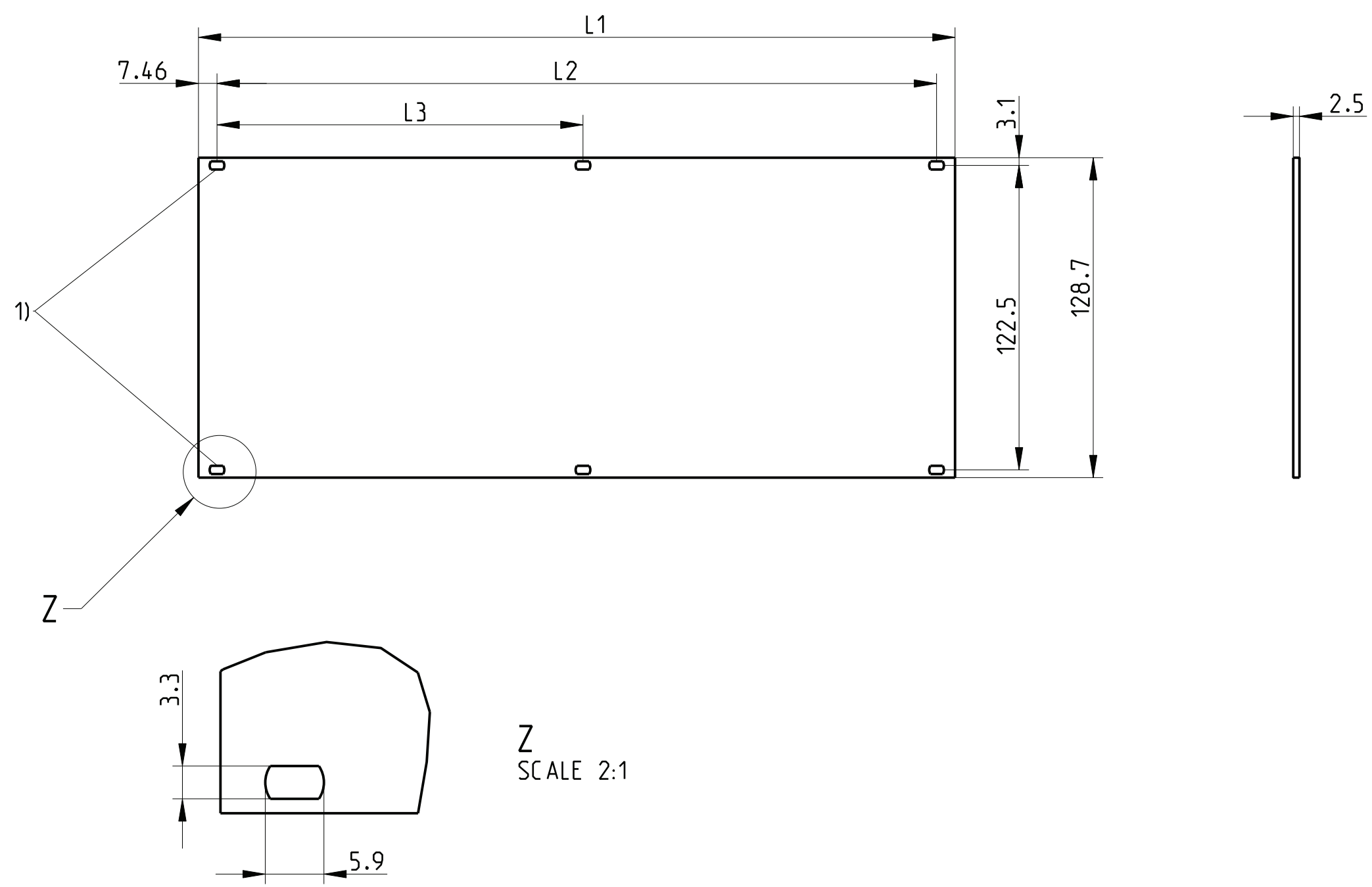

Z
 SCALE 2:1

1) nur bei Ausführung 226 216.0023.02 - Ø2.4
 only version 226 216.0023.02 - Ø2.4

2) farblos eloxiert
 clear anodised

3) Standardprodukt: alle weiteren
 Typen auf Anfrage
 Standard product:
 all other types on request

4) Technische Änderungen vorbehalten
 Subject to change without notice

Dieses Bauteil unterliegt den Reglementierungen der RoHS Richtlinie
 und deren Umsetzung im ElektroG.

This component is subject to the RoHS directive and its applications
 within the Electrical and Electronic Equipment Act (ElektroG).

Art.Nr.	Zeichnungs Nr.	Maße	Art.Nr.	Zeichnungs Nr.	Maße				
Part No.	Drawing No	L1	L2	L3	Part No.	Drawing No	L1	L2	L3
3) 3684889	226 216.0023.02 ¹⁾	9.84	--	--		226 216.0023.49	248.60	233.68	--
3) 3684890	226 216.0023.03	14.92	--	--		226 216.0023.50	253.68	238.76	--
3) 3684891	226 216.0023.04	20.00	--	--		226 216.0023.51	258.76	243.84	--
3) 3684892	226 216.0023.05	25.08	--	--		226 216.0023.52	263.84	248.92	--
3) 3684893	226 216.0023.06	30.16	--	--		226 216.0023.53	268.92	254.00	--
3) 3684894	226 216.0023.07	35.24	--	--		226 216.0023.54	274.00	259.08	--
3) 3684895	226 216.0023.08	40.32	--	--		226 216.0023.55	279.08	264.16	--
	226 216.0023.09	45.00	--	--		226 216.0023.56	284.16	269.24	132.08
3) 3684896	226 216.0023.10	50.48	35.56	--		226 216.0023.57	289.24	274.32	137.16
9907916	226 216.0023.11	55.56	40.64	--		226 216.0023.58	294.32	279.40	142.24
3) 3684897	226 216.0023.12	60.64	45.72	--		226 216.0023.59	299.4	284.48	147.32
	226 216.0023.13	65.72	50.80	--	3) 3684905	226 216.0023.60	304.48	289.56	152.40
3) 3684898	226 216.0023.14	70.80	55.88	--		226 216.0023.61	309.56	294.64	157.48
	226 216.0023.15	75.88	60.96	--		226 216.0023.62	314.64	299.72	162.56
	226 216.0023.16	80.96	66.04	--	3) 3684906	226 216.0023.63	319.72	304.80	167.64
	226 216.0023.17	86.04	71.12	--		226 216.0023.64	324.80	309.88	172.72
	226 216.0023.18	91.12	76.20	--		226 216.0023.65	329.88	314.96	177.80
	226 216.0023.19	96.20	81.28	--		226 216.0023.66	334.96	320.04	182.88
3) 3684899	226 216.0023.20	101.28	86.36	--		226 216.0023.67	340.04	325.12	187.96
3) 3684900	226 216.0023.21	106.36	91.44	--		226 216.0023.68	345.12	330.20	193.04
	226 216.0023.22	111.44	96.52	--		226 216.0023.69	350.20	335.28	198.12
	226 216.0023.23	116.52	101.60	--		226 216.0023.70	355.28	340.36	203.20
	226 216.0023.24	121.60	106.68	--		226 216.0023.71	360.36	345.44	208.28
	226 216.0023.25	126.68	111.76	--		226 216.0023.72	365.44	350.52	213.36
	226 216.0023.26	131.76	116.84	--		226 216.0023.73	370.52	355.60	218.44
3) 3684901	226 216.0023.27	136.84	121.92	--		226 216.0023.74	375.6	360.68	223.52
3) 3684902	226 216.0023.28	141.92	127.00	--		226 216.0023.75	380.68	365.76	228.60
	226 216.0023.29	147.00	132.08	--		226 216.0023.76	385.76	370.84	233.68
	226 216.0023.30	152.08	137.16	--		226 216.0023.77	390.84	375.92	238.76
	226 216.0023.31	157.16	142.24	--		226 216.0023.78	395.92	381.00	243.84
	226 216.0023.32	162.24	147.32	--		226 216.0023.79	401.00	386.08	248.92
	226 216.0023.33	167.32	152.40	--		226 216.0023.80	406.08	391.16	254.00
	226 216.0023.34	172.40	157.48	--		226 216.0023.81	411.16	396.24	259.08
	226 216.0023.35	177.48	162.56	--		226 216.0023.82	416.24	401.32	264.16
	226 216.0023.36	182.56	167.64	--		226 216.0023.83	421.32	406.40	269.24
	226 216.0023.37	187.64	172.72	--	3) 3684907	226 216.0023.84	426.40	411.48	274.32
	226 216.0023.38	192.72	177.80	--		226 216.0023.85	431.48	416.56	279.40
	226 216.0023.39	197.80	182.88	--		226 216.0023.86	436.56	421.64	284.48
3) 3684903	226 216.0023.40	202.88	187.96	--		226 216.0023.87	441.64	426.72	289.56
	226 216.0023.41	207.96	193.04	--		226 216.0023.88	446.72	431.80	294.64
3) 3684904	226 216.0023.42	213.04	198.12	--		226 216.0023.89	451.80	436.88	299.72
	226 216.0023.43	218.12	203.20	--		226 216.0023.90	456.88	441.96	304.80
	226 216.0023.44	223.20	208.28	--		226 216.0023.91	461.96	447.04	309.88
	226 216.0023.45	228.28	213.36	--		226 216.0023.92	467.04	452.12	314.96
	226 216.0023.46	233.36	218.44	--		226 216.0023.93	472.12	457.20	320.04
	226 216.0023.47	238.44	223.52	--		226 216.0023.94	477.20	462.28	325.12
	226 216.0023.48	243.52	228.60	--		226 216.0023.95	482.28	467.36	330.20
						226 216.0023.96	487.36	472.44	335.28

The reproduction, distribution and utilization of this document as well as the communication of its contents to others without explicit authorization is prohibited. All rights reserved in the event of a patent, utility model or design.

CAD

		Toleranzen tolerances		Oberfläche surface 2)		Maßstab/scale 1:2	
e	HT0120	27.05.13	Kör.	Date	13.11.96	Aluminium	
d	R489	27.10.06	FroS	Name	Kon./Fr	Frontplatte 3HE flach	
c	R269	26.04.05	Vish	Prf.	Schaffer	Front panel 3U flat	
b	R098	11.02.03	Glov.	HEITEC		als Leerplatzabdeckung	
Rev.	Rev no.	Date	Name			as filler panel	
						226 216.0023.02-96 MB e	

1
 Blätter
 sheets
 Blatt
 sheet
 1